



## BRUHAT BENGALURU MAHANAGARA PALIKE

Office of  
The Deputy Conservator of Forests,  
Bruhat Bengaluru Mahanagara Palike,  
N R Square, Annex Building - 3, Bengaluru.  
Date: 03.06.2024

No. DCF/PR. -407 /2024-25/

### PUBLIC NOTICE

This is to bring to the notice of the Citizens of Bengaluru that the Chief Engineer, Phase - 2A/P1, BMRCL, Bengaluru, has submitted an application to the undersigned for removal of trees standing on both LHS/RHS of Service Road from Pier No. 140 to Pier No. 175 and at HSR Layout, HSR Metro Station BHS Entry and Exit Structure and at (Agara to Ibbalur RH Site, ORR- Phase 2A, Package – 01) BMRCL Project. The details are given below:

<b>Name of the Project</b>	Construction of Elevated Structures (Viaduct and Stations) of length 9.859 kms from Chainage 0.000 m to 9859.000 m and 06 Nos. of Elevated Metro Stations viz., Central Silk Board, HSR Layout, Agara, Ibbalur, Bellandur, Kadubeesanahalli including Road Widening, Utility diversion & Allied Works of Bengaluru Metro Rail Project Phase -2A			
<b>Name of the Agency</b>	Bangalore Metro Rail Corporation Limited, Bengaluru			
<b>Purpose for removal of trees</b>	The 28 trees are standing on the LHS/RHS side within the project area for the Entry/Exit Structures of HSR Layout Metro Station and 34 trees are standing on LHS/RHS service roads from ORP Pier No. 140 to ORP 175 (Agara to Ibbaluru RH Side) for Viaduct Girder Erection			
<b>Description of the area with clear demarcation of boundaries or with GPS coordinates</b>	<b>Boundary</b>	<b>Latitude (N)</b>	<b>Longitude (E)</b>	<b>Location</b>
	1	12.916908°	77.632644°	
	2	12.916584°	77.632607°	
	3	12.916536°	77.632936°	
	4	12.916806°	77.632983°	
	5	12.91608°	77.63346°	RHS side of the HSR Layout Metro Station, Survey No. 47, BHS Entry/Exit Structure
	6	12.91618°	77.63347°	
	7	12.91617°	77.63249°	
	8	12.91626°	77.63250°	
	9	12.92152°	77.66111°	LHS/RHS service roads, From ORP Pier No. 140 to ORP 175 (Agara to Ibbaluru RH Side) Metro Viaduct of Phase – 2A/P1 Project alignment
	10	12.92167°	77.66115°	
	11	12.92374°	77.65390°	
12	12.92383°	77.65394°		
<b>Enumeration of trees</b> Total no. of trees standing in the project area	62 Nos (Annexure-1)	Description of trees, species, location, area, etc., are uploaded in the website of BBMP for information of all. <a href="http://www.bbmp.gov.in">www.bbmp.gov.in</a>		
Total no. of trees proposed to be removed	62 Nos (Annexure-1)			
<b>Mode of communication of comments</b> (Public can send their comments either by E-mail / Post / Hand)	<b>Address:</b> a. The Deputy Conservator of Forests & Tree Officer, BBMP, N.R Square, Bangalore- 560 002. E-mail id: <a href="mailto:dcfbbmp12@gmail.com">dcfbbmp12@gmail.com</a> b. The Chief Engineer, Ph - 2A/P1, BMRCL, Bengaluru E-mail id: <a href="mailto:sp.sharks76@yahoo.co.in">sp.sharks76@yahoo.co.in</a> ; <a href="mailto:spraghavendra@bmrc.co.in">spraghavendra@bmrc.co.in</a> * * A copy of the comments communicated directly to CE, Phase 2A/P1, BMRCL, should also be marked to the Tree-Officer/DCF, BBMP			
<b>Deadline for filing objections</b>	Ten (10) days from the date of publication of this Notification in Newspaper * <b>Objections/Comments/Suggestions should be relevant and specific to the project</b>			

In view of the above, the suggestions/objections/comments are invited from citizens under Section 8 (3) (vii) of the Karnataka Preservation of Tree Act, 1976.

  
Tree Officer &  
Deputy Conservator of Forests,  
BBMP, Bengaluru



# ಬೃಹತ್ ಬೆಂಗಳೂರು ಮಹಾನಗರ ಪಾಲಿಕೆ

ಉಪ ಅರಣ್ಯ ಸಂರಕ್ಷಣಾಧಿಕಾರಿಗಳು, ಅರಣ್ಯ ಘಟಕ,  
ಬೃಹತ್ ಬೆಂಗಳೂರು ಮಹಾನಗರ ಪಾಲಿಕೆ

ಅನಿಕ್ಸ್ ಜಲ್ಲಂಗ್ - 3, ಎನ್. ಆರ್. ವೃತ್ತ, ಬೆಂಗಳೂರು-560 002.

ಸಂಖ್ಯೆ: ಉಸಂ/ಪಿಆರ್/ 407 /2024-25

ದಿನಾಂಕ: 03.06.2024

## ಸಾರ್ವಜನಿಕ ಪ್ರಕಟಣೆ

ಈ ಮೂಲಕ ಬೆಂಗಳೂರು ಮಹಾನಗರ ಮತ್ತು ಸುತ್ತಮುತ್ತಲಿನ ಸಮಸ್ತ ನಾಗರಿಕರ ಗಮನಕ್ಕೆ ತರಬಯಿಸುತ್ತಿರುವುದೇನೆಂದರೆ, ಮುಖ್ಯ ಅಭ್ಯಂತರರು, ಫೇ 2ಎ/ಪಿ1, ಬಿಎಂಆರ್‌ಸಿಎಲ್, ಬೆಂಗಳೂರು, ಇವರು ಅಗರಯಿಂದ ಇಬ್ಬಲ್ಲೂರುವರೆಗೆ, ಪೀರ್ ಸಂಖ್ಯೆ 140 ಇಂದ ಪೀರ್ ಸಂಖ್ಯೆ 147, ಎಡ ಮತ್ತು ಬಲ ಸೇವಾರಸ್ತೆಗಳಲ್ಲಿ ಮತ್ತು ಎಡ ಮತ್ತು ಬಲ ಭಾಗದ ಎಚ್‌ಎಸ್‌ಆರ್ ಲೇಔಟ್ ಮೆಟ್ರೋ ಸ್ಟೇಷನ್, ' ಒಳಗೆ/ಹೊರಗೆ ಬರುವ ಮಾರ್ಗದ ಕಾಮಗಾರಿಗಳಿಗೆ ಬರುವ ಮರಗಳ ತೆರವಿಗಾಗಿ ಮನವಿ ಸಲ್ಲಿಸಿರುವ ವಿವರಗಳು ಈ ಕೆಳಕಂಡಂತಿರುತ್ತವೆ.

ಯೋಜನೆಯ ಹೆಸರು	Construction of Elevated Structures (Viaduct and Stations) of length 9.859 kms from Chainage 0.000 m to 9859.000 m and 06 Nos. of Elevated Metro Stations viz., Central Silk Board, HSR Layout, Agara, Ibbalur, Bellandur, Kadubeesanahalli including Road Widening, Utility diversion & Allied Works of Bengaluru Metro Rail Project Phase -2A		
ಎಜೆನ್ಸಿಯ ಹೆಸರು	ಬೆಂಗಳೂರು ಮೆಟ್ರೋ ರೈಲು ನಿಗಮ ನಿಯಮಿತ, ಬೆಂಗಳೂರು		
ಮರ ತೆರವುಗೊಳಿಸುವ ಉದ್ದೇಶ	ಯೋಜನಾ ಕಾಮಗಾರಿಗಳಾದ ಒಳಗೆ/ಹೊರಗೆ ಹೋಗುವ ಮಾರ್ಗ, ಎಚ್ ಎಸ್ ಆರ್ ಲೇಔಟ್ ಮೆಟ್ರೋ ನಿಲ್ದಾಣ ನಿರ್ಮಾಣ ಕಾಮಗಾರಿಗೆ 28 ಮರಗಳು, ಮತ್ತು ವಯಡೆಕ್ ಗರ್ಡರ್ ಎರೆಕ್ಷನ್, ಅಗರಯಿಂದ ಇಬ್ಬಲ್ಲೂರುವರೆಗೆ, ಪೀರ್ ಸಂಖ್ಯೆ 140 ಇಂದ ಪೀರ್ ಸಂಖ್ಯೆ 147, ಎಡ ಮತ್ತು ಬಲ ಸೇವಾರಸ್ತೆಗಳಲ್ಲಿ ಇರುವ 34 ಮರಗಳು, ನಿರ್ಮಾಣದ ಕಾಮಗಾರಿಗಳಿಗೆ ಅಡ್ಡ ಬರುತ್ತಿರುವ ಮರಗಳ ತೆರವಿಗಾಗಿ		
ಯೋಜನಾ ಪ್ರದೇಶದ ನಿರ್ದೇಶಾಂಕಗಳು	<b>Boundary</b>	<b>Latitude (N)</b>	<b>Longitude (E)</b>
	1	12.916908°	77.632644°
	2	12.916584°	77.632607°
	3	12.916536°	77.632936°
	4	12.916806°	77.632983°
	5	12.91608°	77.63346°
	6	12.91618°	77.63347°
	7	12.91617°	77.63249°
	8	12.91626°	77.63250°
	9	12.92152°	77.66111°
	10	12.92167°	77.66115°
	11	12.92374°	77.65390°
12	12.92383°	77.65394°	
	<b>Location</b>		
	LHS side of the HSR Layout Metro Station, Survey No. 47, BHS Entry/Exit Structure		
	RHS side of the HSR Layout Metro Station, Survey No. 47, BHS Entry/Exit Structure		
	LHS/RHS service roads, From ORP Pier No. 140 to ORP 175 (Agara to Ibbalur RH Side) Metro Viaduct of Phase – 2A/P1 Project alignment		
ಯೋಜನಾ ಪ್ರದೇಶದಲ್ಲಿ ಪ್ರಸ್ತುತ ಇರುವ ಮರಗಳು	62 ಮರಗಳು (Annexure-1)	ಮರಗಳ ಜಾತಿ, ಅಳತೆಪಟ್ಟಿ ಹಾಗೂ ಮರಗಳಿರುವ ಜಾಗಗಳ ವಿವರಗಳನ್ನು ಬಿಬಿಎಂಪಿ ವೆಬ್ ಸೈಟ್ ನಲ್ಲಿ ಮಾಹಿತಿಗಾಗಿ ಒದಗಿಸಲಾಗಿದೆ. <a href="http://www.bbmp.gov.in">www.bbmp.gov.in</a>	
ಯೋಜನಾ ಪ್ರದೇಶದಲ್ಲಿ ತೆರವುಗೊಳಿಸಬೇಕಾದ ಮರಗಳು	62 ಮರಗಳು (Annexure-1)		
ಆಕ್ಷೇಪಣೆಗಳನ್ನು ಸಲ್ಲಿಸುವ ವಿಧಾನ (ಸಾರ್ವಜನಿಕರು ನೇರವಾಗಿ/ಇ-ಮೇಲ್/ಅಂಚೆ ಮುಖಾಂತರ ಈ ಕೆಳ ಸಹಿದಾರರ ಕಛೇರಿಗೆ ಸಲ್ಲಿಸಬಹುದು)	ವಿಳಾಸ: 1. ಉಪ ಅರಣ್ಯ ಸಂರಕ್ಷಣಾಧಿಕಾರಿ, ಬಿಬಿಎಂಪಿ, ಎನ್.ಆರ್. ಸ್ಟೇಷನ್, ಬೆಂಗಳೂರು - 560002. Email ID: <a href="mailto:dcfbbmp12@gmail.com">dcfbbmp12@gmail.com</a> 2. ಮುಖ್ಯ ಅಭ್ಯಂತರರು, ಫೇ 3&3ಎ/ಪಿ1, ಬಿಎಂಆರ್‌ಸಿಎಲ್, ಬೆಂಗಳೂರು Email ID: <a href="mailto:sp.sharks76@yahoo.co.in">sp.sharks76@yahoo.co.in</a> ; <a href="mailto:spraghavendra@bmrc.co.in">spraghavendra@bmrc.co.in</a> ** * ಆಕ್ಷೇಪಣೆಗಳನ್ನು ಮುಖ್ಯ ಅಭ್ಯಂತರರು, ಬಿಎಂಆರ್‌ಸಿಎಲ್‌ಗೆ ಸಲ್ಲಿಸಿದ್ದಲ್ಲಿ, ಅದರ ಪ್ರತಿಯನ್ನು DCF, BBMP ರವರಿಗೂ ಸಲ್ಲಿಸತಕ್ಕದ್ದು		
ಆಕ್ಷೇಪಣೆಗಳನ್ನು ಸಲ್ಲಿಸಬೇಕಾದ ಅವಧಿ	ಈ ಪ್ರಕಟಣೆ ಹೊರಡಿಸಿದ ದಿನಾಂಕದಿಂದ 10 ದಿನಗಳೊಳಗಾಗಿ ಸಲ್ಲಿಸತಕ್ಕದ್ದು ಸೂಚನೆ: ಆಕ್ಷೇಪಣೆಗಳು ಪ್ರಸ್ತಾವಿತ ಯೋಜನೆಗೆ ಮಾತ್ರ ಸಂಬಂಧಿಸಬೇಕು.		

ಮೇಲ್ಕಂಡ ಪ್ರದೇಶದಲ್ಲಿನ ಮರಗಳನ್ನು ತೆರವುಗೊಳಿಸುವ ಸಂಬಂಧ ಸಾರ್ವಜನಿಕರ ಆಕ್ಷೇಪಣೆ/ಸಲಹೆಗಳಿದ್ದಲ್ಲಿ ಕರ್ನಾಟಕ ವೃಕ್ಷ ಸಂರಕ್ಷಣಾ ಕಾಯಿದೆ 1976 ಸೆಕ್ಷನ್ 8 (3) (vii) ಪ್ರಕಾರ ಸಲಹೆ - ಸೂಚನೆಗಳನ್ನು ನೀಡಲು ಆಹ್ವಾನಿಸಲಾಗಿದೆ.

ವೃಕ್ಷ ಅಧಿಕಾರಿ,  
ಉಪ ಅರಣ್ಯ ಸಂರಕ್ಷಣಾಧಿಕಾರಿ  
ಬಿಬಿಎಂಪಿ, ಬೆಂಗಳೂರು



# ಬೆಂಗಳೂರು ಮೆಟ್ರೋ ರೈಲ್ ನಿಗಮ ನಿಯಮಿತ

(ಕರ್ನಾಟಕ ಸರ್ಕಾರ ಹಾಗೂ ಕೇಂದ್ರ ಸರ್ಕಾರ ಸಹಭಾಗಿತ್ವದ ಉದ್ಯಮ)  
ನೋಂದಾಯಿತ ಕಛೇರಿ : ಬಿ.ಎಂ.ಟಿ.ಸಿ. ಕಾಂಪ್ಲೆಕ್ಸ್, 3ನೇ ಮಹಡಿ, ಕೆಂಗಲ್ ಹನುಮಂತಯ್ಯ ರಸ್ತೆ, ಶಾಂತಿನಗರ  
ಬೆಂಗಳೂರು - 560 027, ಭಾರತ

## Bangalore Metro Rail Corporation Ltd.

(A Joint Venture of Government of Karnataka & Government of India)

Regd. Office : B.M.T.C. Complex, 3rd Floor, K.H. Road, Shanthinagar,  
Bangalore - 560 027. INDIA

No. BMRCL/ORR/PH-2A/P1/2024/253

Date:29.04.2024

To,

The Deputy Conservator of Forest & (Tree Officer),  
BBMP NR Square,  
Bangalore-560002

Sir,

**Project Name: "PHASE 2A/P1/60 (a) :** Construction of elevated structures (Viaduct & Stations) of length 9.859 km from Chainage 0.000 m to 9859.000 m and 6 Nos of elevated metro stations viz, Central Silk Board, HSR layout, Agara, Ibbalur, Bellandur, Kadubeesanahalli including road widening, Utility diversion and allied works of Bengaluru Metro Rail Project Phase-2A & Construction of loops, ramps for road flyover at Central Silk Board junction of approx. length of 2.84 Km including Road widening & allied works in Reach-5 line (R5/P4) of Bengaluru Metro Rail Project, Phase-2.

**Sub:** Regarding permission for the clearance of tree infringing at Metro work at location HSR Metro Station BHS Entry/Exit Structure, Viaduct from ORP 140 to ORP 175 (Agara to Ibbalur RH side, ORR-Phase-2A, Package-1

**Ref:** 1) BMRCL Ltr No: BMRCL/ORR/PH-2A/P1/2024/239/18866 dated 27.02.2024

With reference to above subject, in continuation to the letter at ref (1) above, regarding request for clearance of tree infringing in Metro works.

### HSR Station Entry Structure:

Construction of Metro Rail project of Phase-2A from CSB to KR puram is in progress. In which Station at HSR layout is proposed with two side Entry/Exit and land area of 1560.39 sqm belongs to Survey No 47 for HSR layout Station, Entry/Exit structure at LHS was acquired by BMRCL on 18.01.2019 from BDA for Metro construction. Tree felling permission for 4 nos of Trees were accorded by BBMP vide Official Memorandum dated 09/12/2021. Accordingly Tree no -214,215,216 & 217 were felled.

Further, BMRCL planned RHS Entry Structure after the Nalla side service road and requested BBMP for Tree felling permission of 6 nos of Trees. BBMP vide Official Memorandum dated 19/09/2022 accorded permission for felling of Trees. However, later on due to change in entry structure location these trees were retained without felling.

In the meanwhile, Teachers' Colony Residents Association requested BMRCL for Shifting of HSR station Entry/Exit structure to the adjacent land and stated that, the CA site no:10 which was handed over to BDA by Kendra Upadhyara Sangha (KUS) for the purpose of construction of Community hall. After discussions, feasibility of adjacent BBMP park area has been examined considering the advanced stage of construction of station main box of HSR Station and found that Entry/Exit location is feasible. Due to this shifting on LHS entry,

RHS Entry structure also need to be shifted longitudinally to integrate both side entry to be assembled at concourse level.

Due to change in Entry structure on both sides to new location, the trees infringement needs to be removed in order to take up the construction activities. After detailed analysis, it is found that 28 nos of trees were infringing with entry structure on both sides. Hence requested for Tree removal of 28 nos has been submitted to BBMP Forest wing for approval.

**Viaduct-Erection of U girder by Tandem Lifting:**

Initially, the Superstructure Element U-Girder is planned with overhead Launching Girder erection method, in which the launcher will move above the Piers and U-Girder will be fed from feeding location. For movement of Launcher, it needs continuous span erection for Launching of Girders. Due to the integration of Ph-2A line with Ph-3 line, few piers are yet to be taken up due to various reasons like modification of metro piers, traffic diversion, utilities shifting which shall take considerable time and affecting the completion of Ph-2A project.

In order to complete the project in time, alternative method for erection of Girder has been explored ie., Tandem lifting of the U-girder by using two nos of Cranes of capacity 400 MT to 500 MT. As the capacity of this cranes are high which requires the turning radius for lifting of U- Girder and placing. Trees at Median between Main carriage way and Service road are infringing with in the turning radius of Crane. Details of Infringing trees with crane movement sketch attached. After detailed analysis, it is found that 34 nos of trees to be removed for erecting the U-girder with Crane and in turn, requested for Tree removal of 34 nos to facilitate U-girder erection using tandem Crane.

This is for information and necessary action please.

Thanking You,

Yours faithfully,

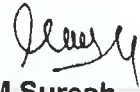

**M.Suresh**

**Chief Engineer-Ph 2A/P1**

**CC to:**

Environmental Officer/SEMU(BMRCL) -For kind information and necessary action please.

**LIST OF TREES INFRINGING HSR STATION ENTRY/EXIT STRUCTURE WORK AT ORR/PKG-1**

<b>RHS</b>						
<b>SL.NO</b>	<b>Old Tree No</b>	<b>New Tree No</b>	<b>SPECIES</b>	<b>GIRTH(M)</b>	<b>HEIGHT(M)</b>	<b>REMARKS</b>
1	3	1	Mahagani	0.71	4	
2	4	2	Mahagani	0.64	3.8	
3	5	3	Tabobia rosea	0.99	3.9	
4	6	4	Mahagani	0.55	4	
	6A	4A		0.38	4	
	6B	4B		0.56	4	
	6C	4C		0.26	4	
5	7	5	Akash mallige	0.3	2.5	
	7A	5A		0.3	2	
6	8	6	Hoovarasi	0.56	3	
	8A	6A		0.46	3	
	8B	6B		0.27	3	
7	9	7	Akash mallige	0.25	2.1	
8	10	8	Tabobia rosea	1.2	3.8	
9	11	9	Akash mallige	0.52	4	
10	12	10	Honge	0.45	2.5	
11	13	11	Akash mallige	0.62	3.4	
12	14	12	Akash mallige	0.25	2.3	
	14A	12A		0.29	2.3	
	14B	12B		0.26	2.3	
13	31	13	Jacaranda	2	3	

<b>LHS</b>						
<b>SL.NO</b>	<b>Tree No</b>	<b>Tree No</b>	<b>SPECIES</b>	<b>GIRTH(M)</b>	<b>HEIGHT(M)</b>	<b>REMARKS</b>
1	20	14	Spethodia	1.67	4	
	20A	14A		0.58	4	
	20B	14B		0.84	4	
	20C	14C		1.06	4	
2	21	15	Spethodia	2.18	4	
	21A	15A		0.37	4	
3	26	16	Mahagani	0.29	4	
4	27	17	Honge	0.27	1.9	
5	28	18	Spethodia	2.17	4.8	
	28A	18A		1.22	4.8	
6	29	19	Jacaranda	0.45	3	
7	30	20	Jacaranda	0.35	4	
	30A	20A		0.2	4	
	30B	20B		0.17	4	
	30C	20C		0.2	4	
8	31	21	Kadubadami	0.36	1.9	
9	36	22	Jacaranda	1.6	4	
10	37	23	Jacaranda	2	4	
11	113	24	Tabubia rosea	1.2	3	
12	115	25	Torematti	0.47	2.2	
13	116	26	Tabubia rosea	0.96	3	
14	117	27	Tabubia rosea	1.1	4.5	
15	118	28	Tabubia rosea	0.67	3.3	

### New Numbering Details ORP 140 -175

SI No	Old Tree No.	New Tree No.	Species	Girth (m)	Height (m)	Remark
1	78	1	Rain Tree	1.5	3.10	
2	79	2	Rain Tree	1.77	3.10	
3	80	3	Rain Tree	1.7	3.10	
4	81	4	Rain Tree	1.75	2.80	
5	82	5	Rain Tree	2.6	3.50	
6	83	6	Mahagani	0.27	2.10	
	83A	6A	Mahagani	0.18	2.10	
7	84	7	Rain Tree	1.92	3.00	
8	85	8	Rain Tree	1.38	5.00	
9	86	9	Rain Tree	1.45	3.10	
10	87	10	Tabubia Rosea	0.27	2.90	
	87A	10A	Tabubia Rosea	0.25	2.90	
	87B	10B	Tabubia Rosea	0.19	2.90	
	87C	10C	Tabubia Rosea	0.15	2.90	
11	88	11	Subabull	0.27	2.00	
12	89	12	Mahagani	0.27	2.10	
	89A	12A	Mahagani	0.18	2.10	
13	90	13	Mahagani	0.22	2.80	
	90A	13A	Mahagani	0.17	2.00	
14	91	14	Tabubia	0.35	2.10	
	91A	14A	Tabubia	0.29	2.10	
15	92	15	Subabull	0.26	2.90	
16	93	16	Tabubia Rosea	0.32	3.00	
	93A	16A	Tabubia Rosea	0.31	3.00	
17	94	17	Tabubia Rosea	0.55	2.50	
18	95	18	Rain Tree	2.1	3.80	
19	96	19	Subabull	0.57	3.40	
	96A	19A	Subabull	0.46	3.40	
20	97	20	Mahagani	0.32	3.00	
21	98	21	Subabull	0.49	3.00	
	98A	21A	Subabull	0.47	3.00	
22	99	22	Subabull	0.75	3.10	
23	100	23	Honge	0.29	1.80	
24	101	24	Subabull	0.48	3.00	
25	102	25	Honge	0.28	1.90	
26	103	26	Honge	0.25	20.00	
27	104	27	Subabull	0.3	1.90	
28	105	28	Honge	0.31	1.80	
29	106	29	Rain Tree	2.5	3.80	
30	107	30	Tabubia Rosea	0.19	2.10	
31	108	31	Rain Tree	0.64	3.00	
	108A	31A	Rain Tree	0.48	3.00	
	108B	31B	Rain Tree	0.32	3.00	
32	109	32	Tabubia Rosea	0.19	1.90	
33	110	33	Subabull	0.33	2.50	
34	111	34	Rain Tree	1.85	3.50	

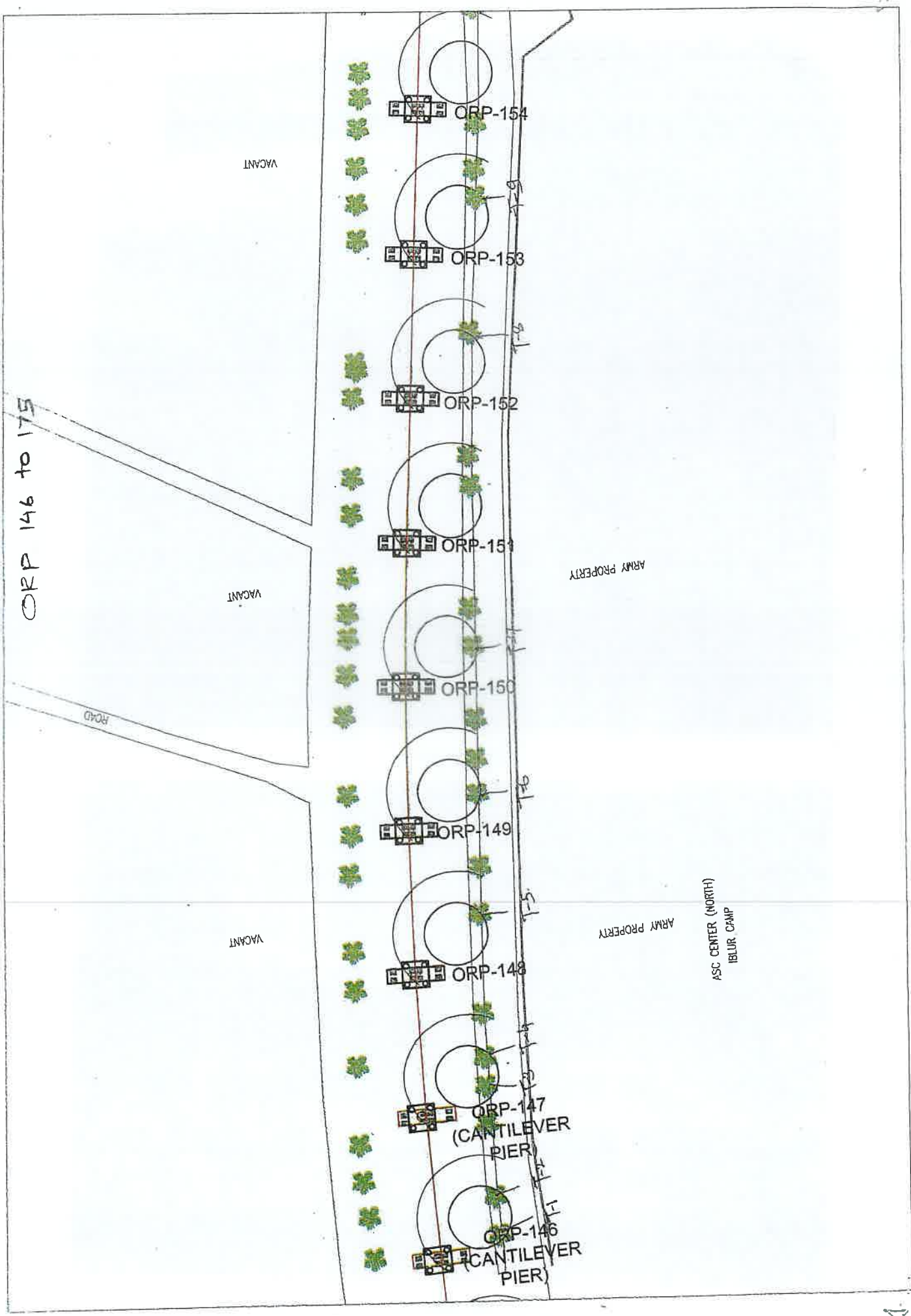

ORP 146 to 175

VACANT

VACANT

ROAD

VACANT

ORP-154

ORP-153

ORP-152

ORP-151

ORP-150

ORP-149

ORP-148

ORP-147  
(CANTILEVER  
PIER)

ORP-146  
(CANTILEVER  
PIER)

ARMY PROPERTY

ARMY PROPERTY

ASC CENTER (NORTH)  
IBLUR CAMP



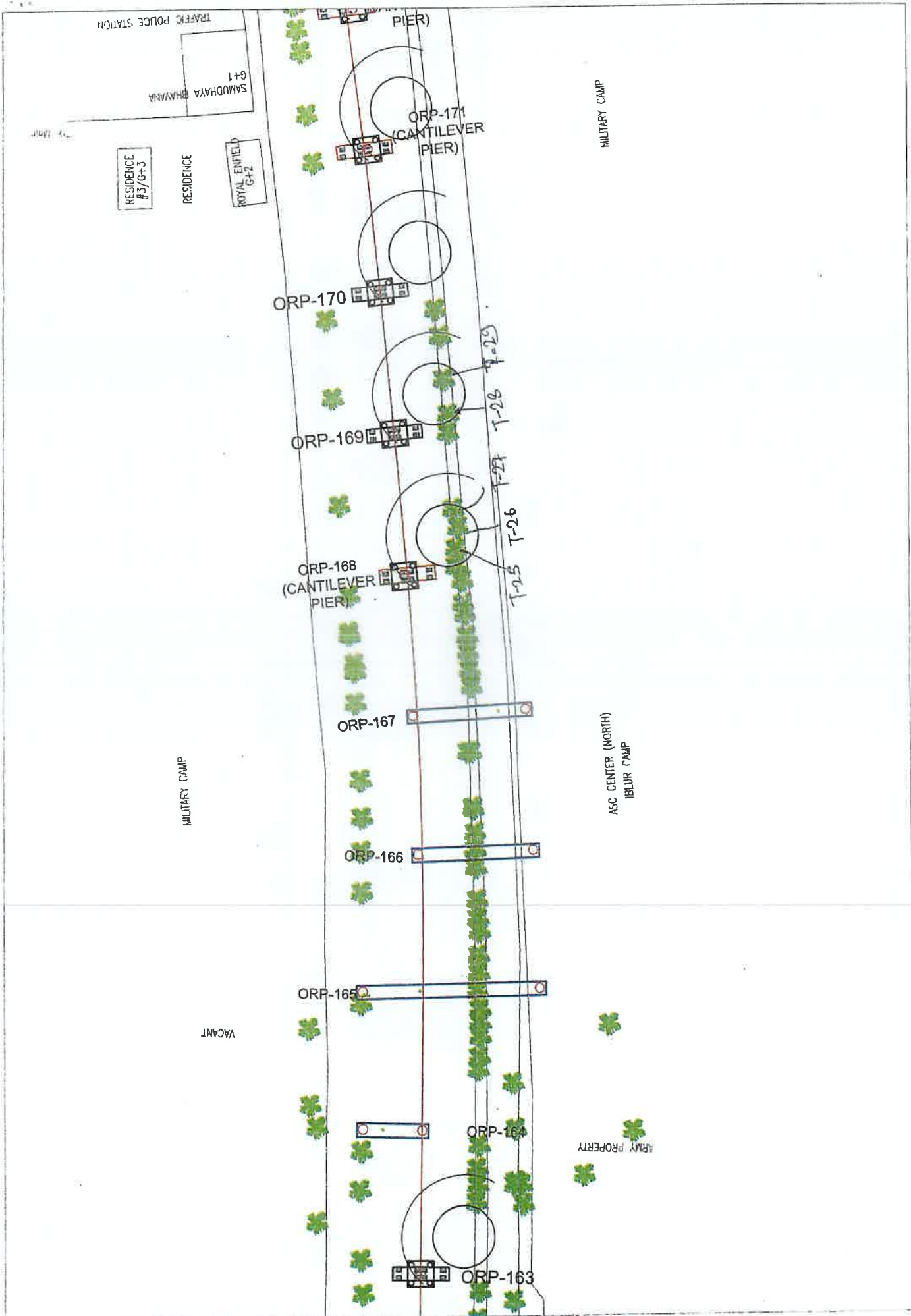







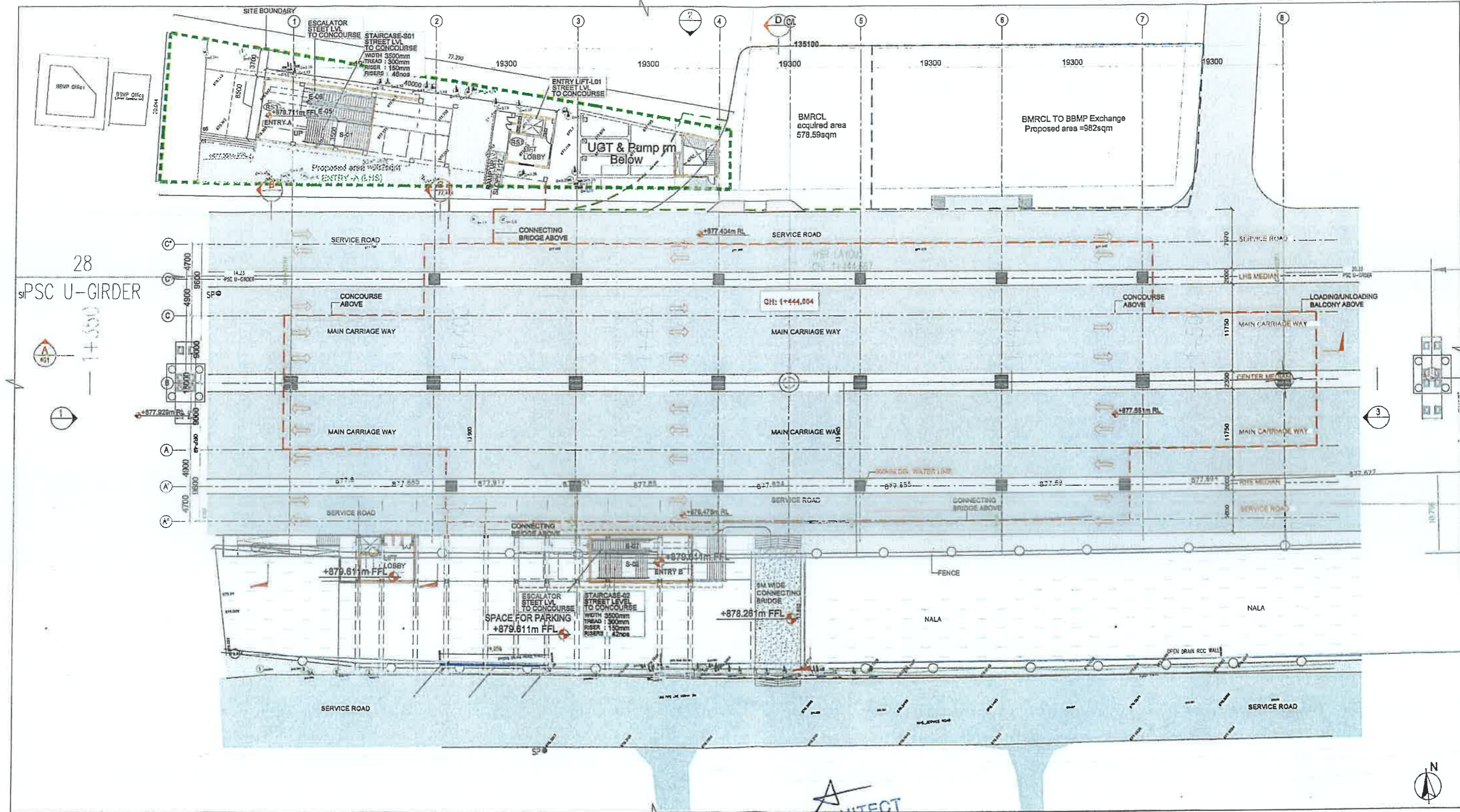

28  
PSC U-GIRDER

1 STREET LEVEL PLAN  
SCALE 1:250

CHIEF ARCHITECT  
(PLANNING & DESIGN)  
BMRCL

NOTES :

ALL DIMENSIONS ARE IN MILLIMETERS & LEVELS ARE IN METERS (UNLESS NOTED OTHERWISE)

ALL DIMENSIONS ARE TO BE READ AND NOT MEASURED.

THIS DRAWING MUST BE READ IN CONJUNCTION WITH GAD, GENERAL NOTES, SPAN ARRANGEMENT AND OTHER RELATED STRUCTURAL DRAWINGS.

ANY DISCREPANCIES MUST BE BROUGHT TO THE NOTICE OF THE P&D BMRCL.

REV.	DATE	DESCRIPTION	DRAWN	CHKD.	APPR.
R4	09-02-2024	ENTRY STRUCTURE LOCATION SHIFTED	RV	RV	AK
R3	29-12-2023	GFC	PN	DM	SKP
R2	23-09-2023	GFC	SS	SP	SJ
R1	21-12-2021	GFC	SS	SP	SJ
R0	10-12-2021	GFC	SS	SP	SJ

GENERAL NOTES :-

- SIZE AND LOCATION OF COLUMN SHALL BE REFERRED FROM STRUCTURAL DRAWINGS
- CONTRACTOR SHALL ENSURE THAT ALL EXPANSION JOINTS & CONSTRUCTION JOINTS ARE WATERTIGHT.
- E&M OPENING AND CUT-OUT SHOWN IN THE DRAWINGS ARE INDICATIVE ONLY, ACTUAL SIZE OF CUTOUT AND OPENING AS PER E&M / HVAC DRAWING.
- EARTH MAT AND EARTH PIT LOCATION SHOULD BE AS PER E&M DRAWING.
- ROOF DESIGN SHOWN ARE TENTATIVE
- FLOOR JOINTS & EXPANSION JOINTS TO BE FOLLOWED AS PER STRUCTURAL DRAWING.
- RAIN WATER DOWN TAKE PIPES SHALL BE PROVIDED IN MEP DRAWINGS.
- LIFT ARCHITRAVE WALL SHALL BE CONSTRUCTED AFTER LIFT INSTALLED
- SOLAR PANELS ARE INDICATIVE. THE NUMBERS AND SPECIFICATION TO BE AS PER VENDOR DETAIL

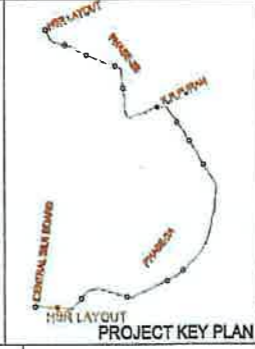

BANGALORE METRO RAIL CORPORATION LTD 3rd Floor, BMRCL Complex, H Road, Shanthinagar, Bangalore - 560027 Tel: 080-22999300	
PROJECT TITLE: PHASE 2A- CH 0+000 TO CH 18+433 PHASE 2B- CH 0+000 TO CH 6+740	
DWG TITLE: HSR LAYOUT STATION STREET LEVEL PLAN	
Drawing Checked By: <i>[Signature]</i> Design Checked By: <i>[Signature]</i>	SCALE: 1:250 DATE (FOR ISSUE): 10.12.2021 DATE (FOR ISSUE): 09.02.2024
DWG NO. BMRC-7061581-502-HSMR-ARC-DWG-102 ISSUE R4	

P&D - ARCHITECTURAL

TO SILK BOARD

TO K.R.PURAM

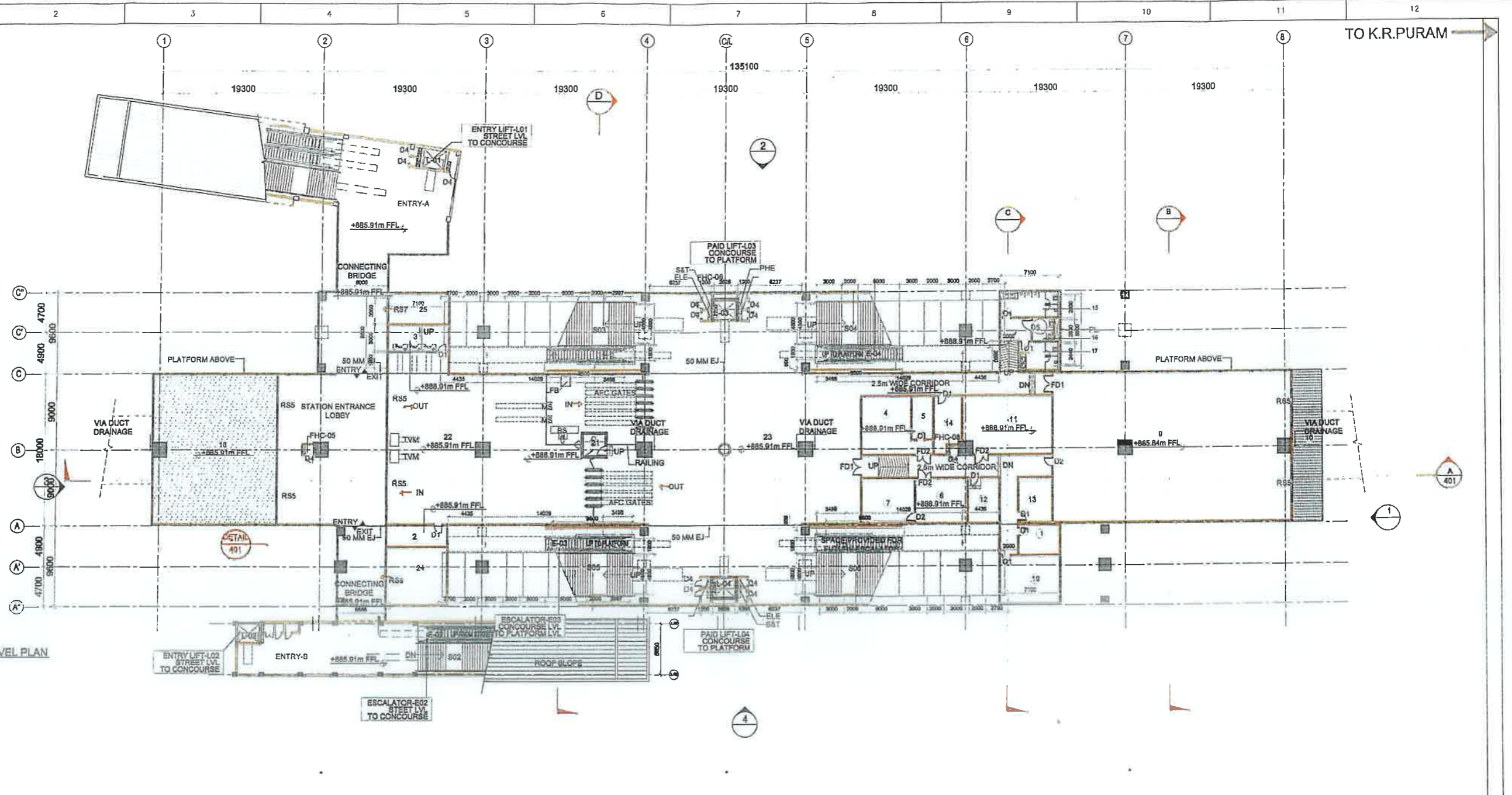

1 CONCOURSE LEVEL PLAN SCALE 1:250

ROOM NO	NAME	AREA	LEVEL	FIRE DOOR	RAISED FLOOR
1	CDMA	18.84 m <sup>2</sup>	CONCOURSE LEVEL		
2	SECURITY ROOM	17.71 m <sup>2</sup>	CONCOURSE LEVEL		
3	TOM	21.26 m <sup>2</sup>	CONCOURSE LEVEL	YES	
4	STATION CONTROL ROOM	44.01 m <sup>2</sup>	CONCOURSE LEVEL	YES	YES
5	AUDIT & CASH	12.00 m <sup>2</sup>	CONCOURSE LEVEL	YES	YES
6	S&T UPS ROOM	31.72 m <sup>2</sup>	CONCOURSE LEVEL	YES	YES
7	BATTERY ROOM	32.76 m <sup>2</sup>	CONCOURSE LEVEL	YES	YES
9	AUXILIARY SUBSTATION	506.08 m <sup>2</sup>	CONCOURSE LEVEL	YES	YES
10	LOADING/UNLOADING DECK	83.00 m <sup>2</sup>	CONCOURSE LEVEL		
11	TELECOM EQUIPMENT ROOM	70.83 m <sup>2</sup>	CONCOURSE LEVEL	YES	YES
12	MAINTAINER'S ROOM	17.15 m <sup>2</sup>	CONCOURSE LEVEL		
13	STORE ROOM	13.52 m <sup>2</sup>	CONCOURSE LEVEL		
14	CLEANER'S ROOM	19.44 m <sup>2</sup>	CONCOURSE LEVEL		
15	GENTS TOILET	14.50 m <sup>2</sup>	CONCOURSE LEVEL	YES	
16	PH TOILET	4.51 m <sup>2</sup>	CONCOURSE LEVEL	YES	
17	LADIES TOILET	13.82 m <sup>2</sup>	CONCOURSE LEVEL	YES	

ROOM NO	NAME	AREA	LEVEL	FIRE DOOR	RAISED FLOOR
18	PROPERTY DEVELOPMENT	258.24 m <sup>2</sup>	CONCOURSE LEVEL		
19	ODU BALCONY	25.91 m <sup>2</sup>	CONCOURSE LEVEL		
21	EFO	0.25 m <sup>2</sup>	CONCOURSE LEVEL		YES
22	UNPAID CONCOURSE	635.57 m <sup>2</sup>	CONCOURSE LEVEL		
23	PAID CONCOURSE	598.22 m <sup>2</sup>	CONCOURSE LEVEL		
24	UNASSIGNED ROOM	32.27 m <sup>2</sup>	CONCOURSE LEVEL		
25	UNASSIGNED ROOM	11.79 m <sup>2</sup>	CONCOURSE LEVEL		
26	DG ROOM	70.35 m <sup>2</sup>	STREET LEVEL		
27	PUMP ROOM	94.75 m <sup>2</sup>	STREET LEVEL		

TYPE MARK	HEIGHT	WIDTH	COUNT	DESCRIPTION
FD1	2500	2000	3	DOUBLE LEAF 2HR FIRE RATED
FD2	2400	1700	4	DOUBLE LEAF 2HR FIRE RATED
D1	2100	1000	9	SINGLE LEAF DOOR
D2	2100	1000	7	SINGLE LEAF DOOR
D3	2400	1000	2	SINGLE LEAF DOOR
D4	2100	750	34	SINGLE LEAF DOOR
D5	2100	1200	1	SINGLE LEAF DOOR
RS1	3000	1800	2	ROLLING SHUTTER
RS2	3500	3000	2	ROLLING SHUTTER
RS3	3000	7000	1	ROLLING SHUTTER
RS4	3000	2000	1	ROLLING SHUTTER
RS5	4000	4000	6	ROLLING SHUTTER
RS6	2500	2000	1	ROLLING SHUTTER
RS7	2500	1650	1	ROLLING SHUTTER
RS8	3000	5300	1	ROLLING SHUTTER

LEGEND :-	DESCRIPTION
FHC	FIRE HOSE CABINET
PHE	PLUMBING & DRAINAGE SHAFT
S & T	SIGNALLING & TELECOM
ELE	ELECTRICAL SHAFT
EOP	ESCALATOR CONTROL PANEL
PL	PLUMBING SHAFT
WG	WICKET GATE

**CHIEF ARCHITECT**  
(PLANNING & DESIGN)  
BMRCL

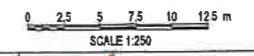

**NOTES :**  
ALL DIMENSIONS ARE IN MILLIMETERS & LEVELS ARE IN METERS (UNLESS NOTED OTHERWISE)  
ALL DIMENSIONS ARE TO BE READ AND NOT MEASURED.  
THIS DRAWING MUST BE READ IN CONJUNCTION WITH GAD, GENERAL NOTES, SPAN ARRANGEMENT AND OTHER RELATED STRUCTURAL DRAWINGS.  
ANY DISCREPANCIES MUST BE BROUGHT TO THE NOTICE OF THE P&D BMRCL.

REV.	DATE	DESCRIPTION	DRAWN	CHKD.	APPR.
R4	09-02-2024	ENTRY STRUCTURE LOCATION SHIFTED	RV	RV	AK
R3	29-12-2022	GFC	PN	DM	SKP
R2	23-08-2022	GFC	SS	SP	SJ
R1	21-12-2021	GFC	SS	SP	SJ
R0	10-12-2021	GFC	SS	SP	SJ

**GENERAL NOTES :-**

- SIZE AND LOCATION OF COLUMN SHALL BE REFERRED FROM STRUCTURAL DRAWINGS
- CONTRACTOR SHALL ENSURE THAT ALL EXPANSION JOINTS & CONSTRUCTION JOINTS ARE WATERTIGHT.
- E&M OPENING AND CUT-OUT SHOWN IN THE DRAWINGS ARE INDICATIVE ONLY. ACTUAL SIZE OF CUTOUT AND OPENING AS PER E&M / HVAC DRAWING.
- EARTH MAT AND EARTH PIT LOCATION SHOULD BE AS PER E&M DRAWING.
- ROOF DESIGN SHOWN ARE TENTATIVE
- FLOOR JOINTS & EXPANSION JOINTS TO BE FOLLOWED AS PER STRUCTURAL DRAWING.
- RAIN WATER DOWN TAKE PIPES SHALL BE PROVIDED IN MEP DRAWINGS.
- LIFT ARCHITRAVE WALL SHALL BE CONSTRUCTED AFTER LIFT INSTALLED
- SOLAR PANELS ARE INDICATIVE. THE NUMBERS AND SPECIFICATION TO BE AS PER VENDOR DETAIL

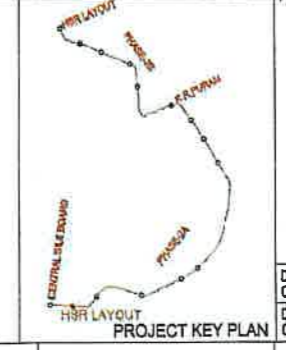

<b>BANGALORE METRO RAIL CORPORATION LTD</b> A-3rd Floor, BMRCL Complex, K.H. Road, Shanthinagar, Bangalore - 560027 Tel:-080-22889300	
<b>PROJECT TITLE:</b> PHASE 2A- CH: 0+000 TO CH: 18+433 PHASE 2B- CH: 0+000 TO CH: 6+740	
<b>DWG TITLE:</b> HSR LAYOUT STATION CONCOURSE LEVEL PLAN	
<b>Drawing Checked By:</b> 	<b>DATE (NO ISSUE):</b> 10.12.2021
<b>Design Checked By:</b> 	<b>DATE (CURRENT ISSUE):</b> 09.02.2024
<b>SCALE:</b> 1:250	<b>DWG NO.:</b> BMRC-7061581-S02-HSMR-ARC-DWG-103
<b>ISSUE:</b> R4	<b>P&amp;D - ARCHITECTURAL</b>